

ACTIVITY SHEET - Number System

Number System Maze

Use your answers to navigate through the maze.

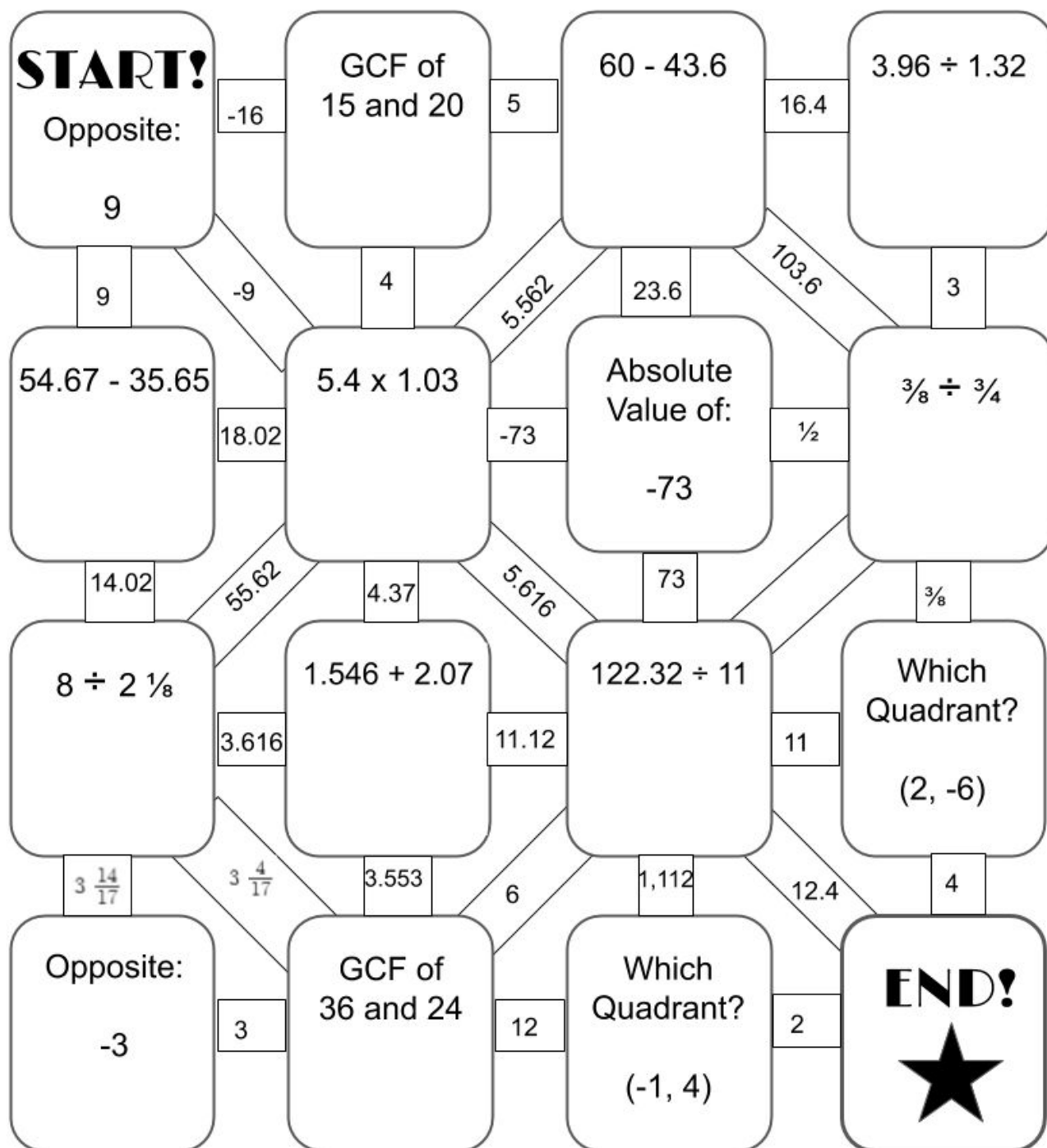

ACTIVITY SHEET - Expressions and Equations

Equations & Expressions Riddle

Directions: Solve for the variable. Then write the letter above the line that the answer corresponds to.

Where do sheep go to get their haircut?

23

8

5

81

7

6

86

44

6

40

14

16

18

<p>B</p> <p>$(36 \div 4) \times 3^2$</p>	<p>A</p> <p>Solve for x.</p> <p>$14 + x = 21$</p>	<p>O</p> <p>Solve for x.</p> <p>$9x = 144$</p>	<p>P</p> <p>If $g = 6$ and $b = 3$, solve</p> <p>$7g - (8 \times b)$</p>
<p>H</p> <p>Solve for x.</p> <p>$8x = 64$</p>	<p>S</p> <p>$18 + (5^2 - 14) \times 2$</p>	<p>A</p> <p>$(48 \div 4) + (2 \times 4^2)$</p>	<p>E</p> <p>What is the missing value?</p> <p>$p + 4p - f$ can be simplified into <input type="text"/> $p - f$.</p>
<p>T</p> <p>If $e = 4$ and $f = 6$, solve</p> <p>$5e + (18 \div f)$</p>	<p>A</p> <p>What is the missing value?</p> <p>$8a + b - 2a$ can be simplified into <input type="text"/> $a + b$.</p>	<p>B</p> <p>Solve for x.</p> <p>$X - 34 = 52$</p>	<p>H</p> <p>Solve for x.</p> <p>$X + 18 = 32$</p>

ACTIVITY SHEET - Geometry page 1 of 2

Directions: Use the following information on the sketch below to answer the corresponding questions.

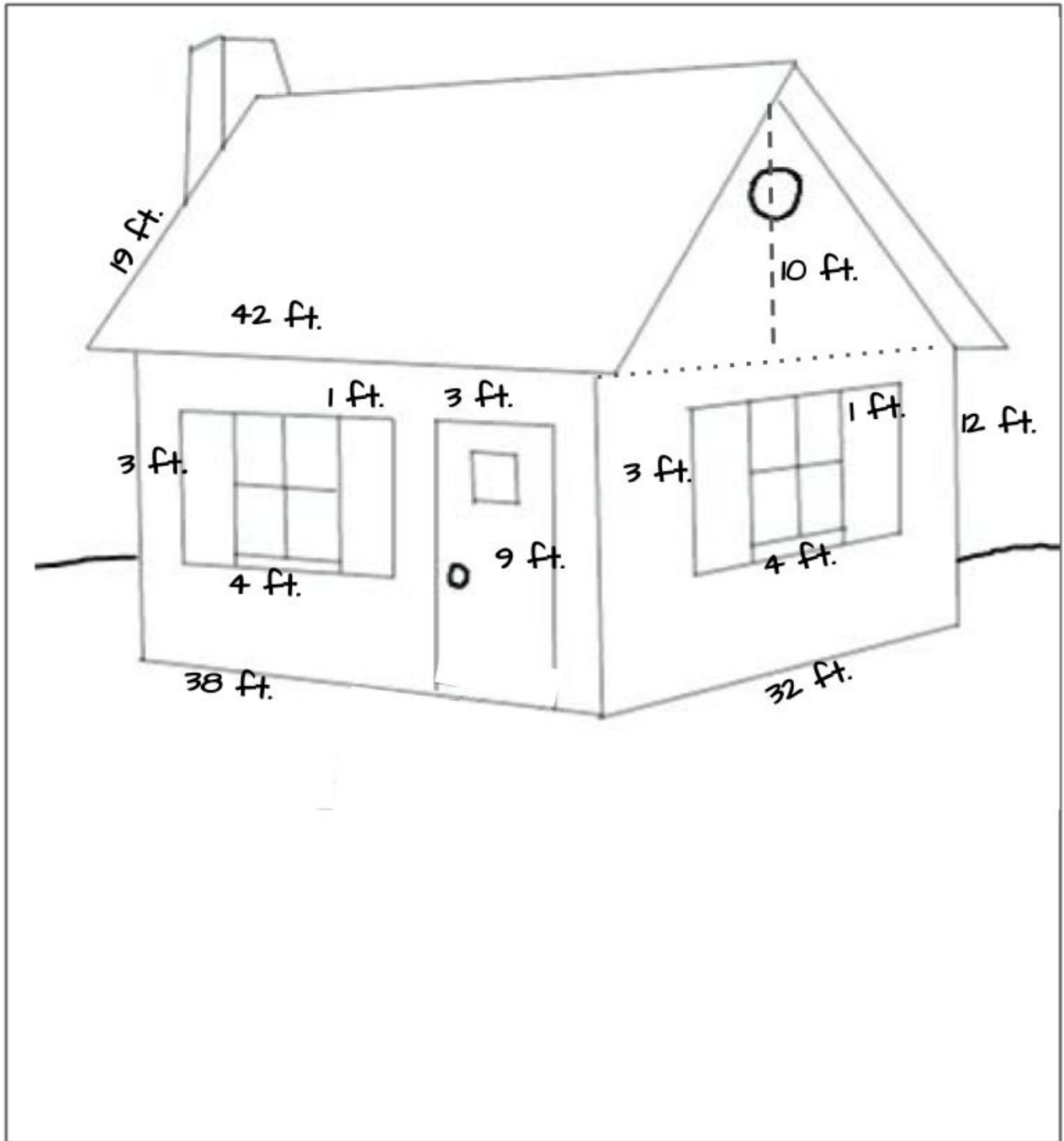

Questions on Next Page →

ACTIVITY SHEET - Geometry page 2 of 2

Directions: Complete the table below. Determine the surface areas for all parts of the house.

Parts of House	Sketch	Measurements	Surface Area
Window(just draw one)			
Front Door			
Roof			
Base (Floor plan of home)			
Outside Wall:			

What would the surface area of the front wall be without the window and door?

ACTIVITY SHEET - Statistics and Probability page 1 of 2

What is Your City & State?

Locate your city and state on the map below. (mark with a star)



Record the high temperature for the next 10 days.

Date	Temp	Date	Temp	Date	Temp

Continues on Next Page →

ACTIVITY SHEET - Statistics and Probability page 2 of 2

Complete each box with the data from the dataset.

MODE:

RANGE:

Identify the median, quartiles and IQR of the data set.

MEAN:

MEAN ABSOLUTE DEVIATION:

Create a line plot with the data from the data set. Identify any peaks, gaps, clusters, and outliers.



ACTIVITY SHEET - RATIOS & PROPORTIONS page 1 of 2

Directions: Solve each problem and then find the answer on the coloring sheet. Color it with the given color in the box.

<p>1. If a 24-oz bottle of Pepsi costs \$2.16, what is the cost per ounce?</p> <p>Color this answer red.</p>	<p>2. Find the value of x in the given proportion.</p> $\frac{5}{9} = \frac{x}{54}$ <p>Color this answer light blue.</p>
<p>6. Samantha bought 4 shirts for \$36.00. At this rate, how much would she pay for 7 shirts?</p> <p>Color this answer purple.</p>	<p>7. An 8-lb bag of oranges cost \$5.12. What is the cost per pound?</p> <p>Color this answer a color of your choice!</p>
<p>1. If a 24-oz bottle of Pepsi costs \$2.16, what is the cost per ounce?</p> <p>Color this answer red.</p>	<p>2. Find the value of x in the given proportion.</p> $\frac{5}{9} = \frac{x}{54}$ <p>Color this answer light blue.</p>
<p>6. Samantha bought 4 shirts for \$36.00. At this rate, how much would she pay for 7 shirts?</p> <p>Color this answer purple.</p>	<p>7. An 8-lb bag of oranges cost \$5.12. What is the cost per pound?</p> <p>Color this answer a color of your choice!</p>
<p>1. If a 24-oz bottle of Pepsi costs \$2.16, what is the cost per ounce?</p> <p>Color this answer red.</p>	<p>2. Find the value of x in the given proportion.</p> $\frac{5}{9} = \frac{x}{54}$ <p>Color this answer light blue.</p>



ACTIVITY SHEET - RATIOS & PROPORTIONS page 2 of 2

The diagram consists of a large square divided into four quadrants by a vertical and a horizontal line. Each quadrant contains a grid of numbers and ratios. The numbers are arranged as follows:

- Top-Left Quadrant:** A grid of numbers: 0.09 (top-left), 63 (top-middle), 21:35 (top-right), 0.64 (middle-left), 63 (middle-middle), 26.25 (middle-right), 0.64 (bottom-left), 21:35 (bottom-middle), 0.09 (bottom-right). The number 30 is circled in the top-middle position.
- Top-Right Quadrant:** A grid of numbers: 0.09 (top-left), 63 (top-middle), 21:35 (top-right), 0.64 (middle-left), 63 (middle-middle), 26.25 (middle-right), 0.64 (bottom-left), 21:35 (bottom-middle), 0.09 (bottom-right). The number 30 is circled in the top-middle position.
- Bottom-Left Quadrant:** A grid of numbers: 0.09 (top-left), 63 (top-middle), 21:35 (top-right), 0.64 (middle-left), 63 (middle-middle), 26.25 (middle-right), 0.64 (bottom-left), 21:35 (bottom-middle), 0.09 (bottom-right). The number 30 is circled in the top-middle position.
- Bottom-Right Quadrant:** A grid of numbers: 0.09 (top-left), 63 (top-middle), 21:35 (top-right), 0.64 (middle-left), 63 (middle-middle), 26.25 (middle-right), 0.64 (bottom-left), 21:35 (bottom-middle), 0.09 (bottom-right). The number 30 is circled in the top-middle position.

Additional numbers are placed around the quadrants:

- At the top center: 40 (above the 30), 30 (circled), 40 (above the 30).
- At the bottom center: 4:28 (below the 30), 30 (circled), 4:28 (below the 30).
- At the far left: 0.68 (written vertically).
- At the far right: 0.68 (written vertically).